

HSE ROHS

REV	ECN NO	DESCRIPTION	DATE	NAME
A		NEW		

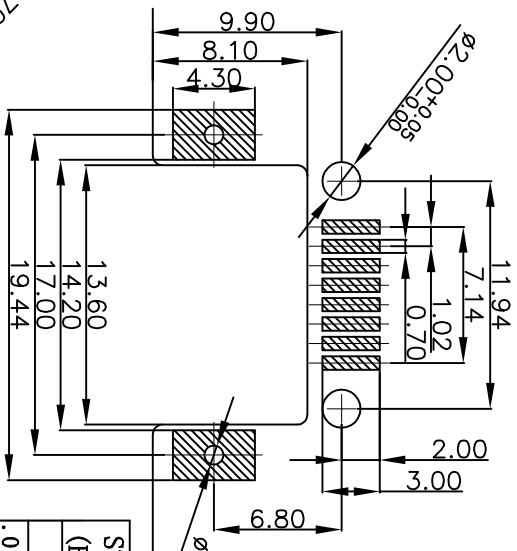
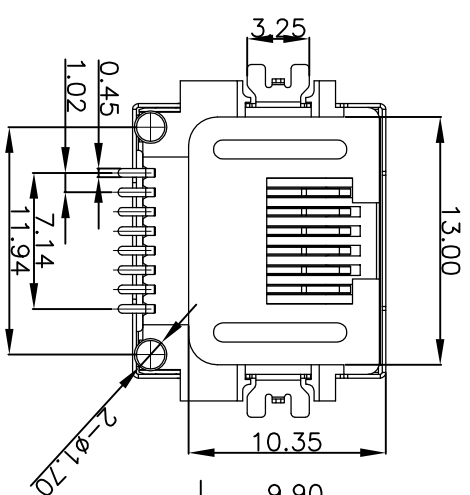
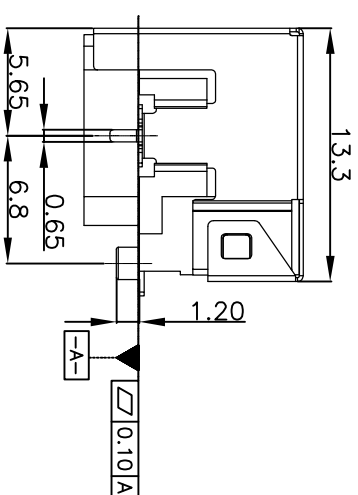
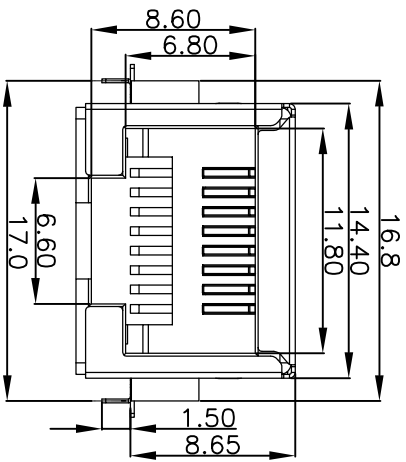
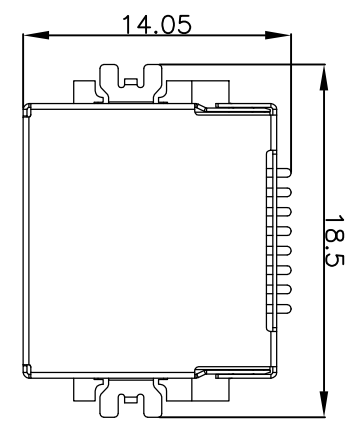
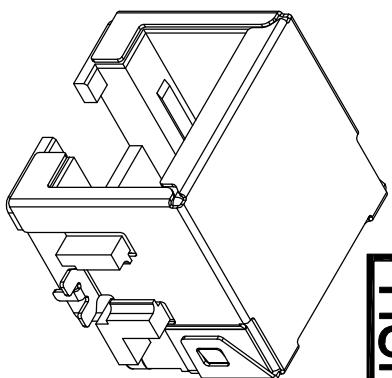

RECOMMEND P.C.B Layout
PCB TOLERANCE:±0.05

- NOTE:
- MATERIAL:
 - SHIELD: BRASS, T=0.2mm
 - HOUSING: LCP, G/F FILLED, UL94V-0 RATED OR OTHER HIGH PERFORMANCE RESINS. COLOR IN BLACK.
 - TERMINAL: PHOSPHOR BRONZE, T=0.30mm
 - CONTACT PLATED: GOLD
 - PCB TOLERANCES: DIMENSION ±0.05
 - RETENTION FORCE OF PLUG IN THE JACK IS 10 kgf (min).
 - SPECIFICATION:

DIELECTRIC STRENGTH: AC 500V FOR ONE MINUTE
 INSULATION RESISTANCE: 100MΩ min. AT DC 100V
 CONTACT RESISTANCE: 45mΩ max.
 CURRENT RATING: 500mA
 OPERATING TEMPERATURE: -30℃~+85℃

Ordering Information

L600XX - X X XX X

insulation height 86-8.6
 1=Forward
 2=Reverse
 Material
 Option
 3=V6T
 4=LCP
 Serial NO. 01-99
 Packing
 C=Tray
 D=Reel

STANDARD TOLERANCE (EXCEPT SPECIFIED)	LINER	ANGLES
±0.30	0.°	±3°
±0.25	.0°	±2°
±0.15	.00°	±1°

LDCONN 东莞连大精密制品有限公司 Dongguan LianDa Precision Products Co., LTD		RT45 8P8C Sinking board type 18.6 SWF Forward		DRAWN BY LuJunhui	DATE 18.04.17
TITLE L60086-140XC	CHECKED BY	DRAWING NO	APPROVED BY	SCALE 1:1	UNIT mm
PART NO	CHECKED BY	DRAWING NO	APPROVED BY	PAGE 1/1	SIZE A4